

HMF EXPRESS

Anchoring Options - Drywall

①

MULTI PURPOSE ANCHORS

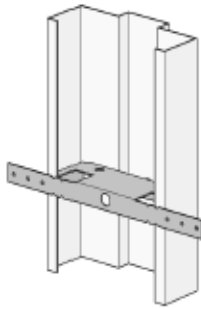

AVAILABLE FOR JAMB DEPTHS FROM
5 3/4" TO 8 3/4" IN 1/2 INCREMENTS
SHIPPED LOOSE

②

COMPRESSION ANCHORS

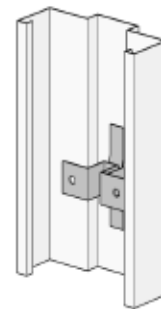

USED IN CONJUNCTION WITH
COUNTERSUNK HOLES OR BASE CLIPS

③

STEEL STUD ANCHORS

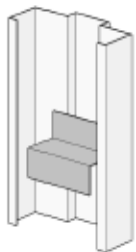

16 GA. WELDED TO FRAME
USED IN CONJUNCTION
WITH BASE ANCHORS:⑥

④

FIRE RATED WOOD STUD ANCHORS

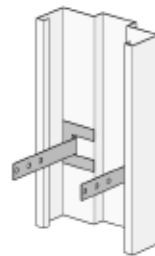

WELDED TO FRAME USED IN
CONJUNCTION WITH BASE ANCHORS:⑥

⑤

UNIVERSAL WOOD STUD ANCHORS

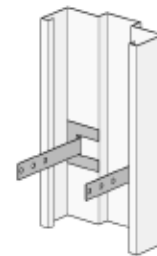

WELDED TO FRAME USED IN
CONJUNCTION WITH BASE ANCHORS:⑥

⑥

BASE ANCHORS



WELDED TO FRAME
(OPTIONAL)

⑦

BASE CLIPS

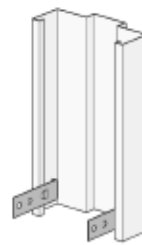

OPTIONAL FOR USE WITH DRYWALL
COMPRESSION ANCHORS:②
1 1/2" & 2" FACES ONLY
2 PER JAMB (SNAP IN)

⑧

COUNTERSUNK HOLE BASE ANCHORS



OPTIONAL FOR USE WITH DRYWALL
COMPRESSION ANCHORS:②

Anchoring Options - Masonry

①

MULTI PURPOSE ANCHOR

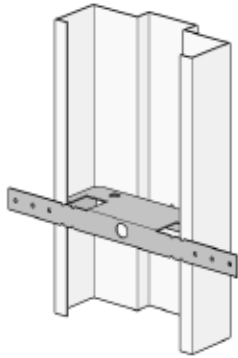

AVAILABLE FOR JAMB DEPTHS FROM
5 3/4" TO 8 3/4" IN 1/2 INCREMENTS
SHIPPED LOOSE

②

EXISTING MASONRY WALL ANCHOR
(BUTTERFLY ANCHOR)

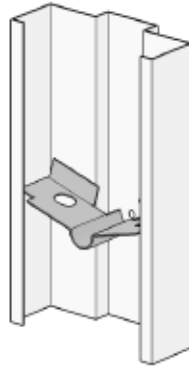

EXISTING MASONRY WALL ANCHOR
ADJUSTABLE FROM 4 1/2" TO 6 3/4"

④

STEEL STUD "Z" ANCHORS

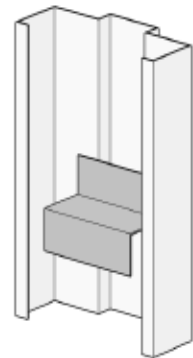

STEEL STUD "Z" ANCHOR 3 PER JAMB,
6 PFR FRAME LOCATED JUST ABOVE
HINGE REINFORCEMENTS

⑤

WIRE ANCHOR

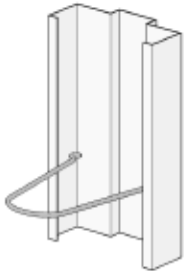

NEW MASONRY WALL WIRE
ANCHOR ADJUSTABLE FROM
4 1/2" TO 8 3/4"
SHIPPED LOOSE

⑥

"T" ANCHOR

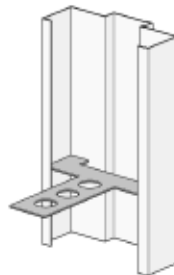

"T" ANCHOR
SHIPPED LOOSE

⑦

ADJUSTABLE STRAP ANCHOR

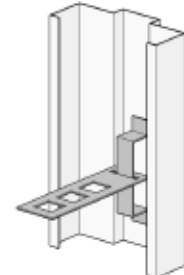

ADJUSTABLE WELD IN
STRAP ANCHOR

⑧

EXISTING MASONRY ANCHOR
(PIPE SLEEVE ANCHOR)



EXISTING MASONRY ANCHOR
(EMA) WELDED IN

⑨

BASE ANCHORS



WELDED IN BASE ANCHOR
STANDARD ON MASONRY FRAMES
EXCEPT WHEN USED WITH EXISTING
WALL ANCHORS

⑩

PUNCH & DIMPLE



OPTIONAL PUNCH & DIMPLE
FOR EXISTING WALL ANCHORS
FOR 3/8" BOLT

HMF EXPRESS

Anchoring Options - Punch and Dimple

