

## Removable Panel Clips

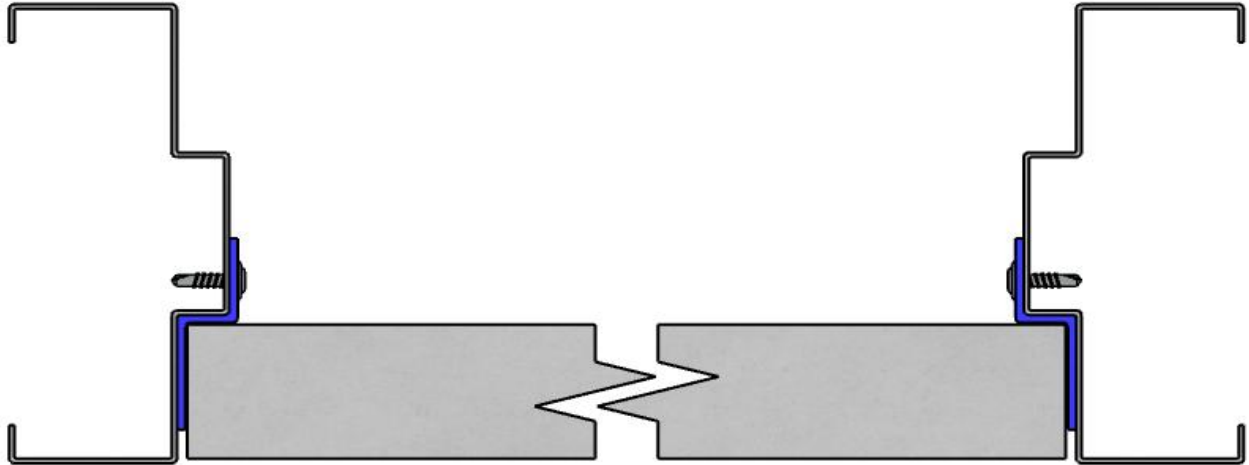

### **Panel clips are shown in Blue.**

Panel Clips are welded to the 1 3/4" ends (sides) of Panel.

Panel Clips attached by screws through Clip and Frame Soffit.

Can be fire rated for use in HMF Express transom frames

Panel can be installed prior to shipment for use on welded frames.

Available on any gauge panel.

Not intended for use on panels less than 1 3/8" thick.